

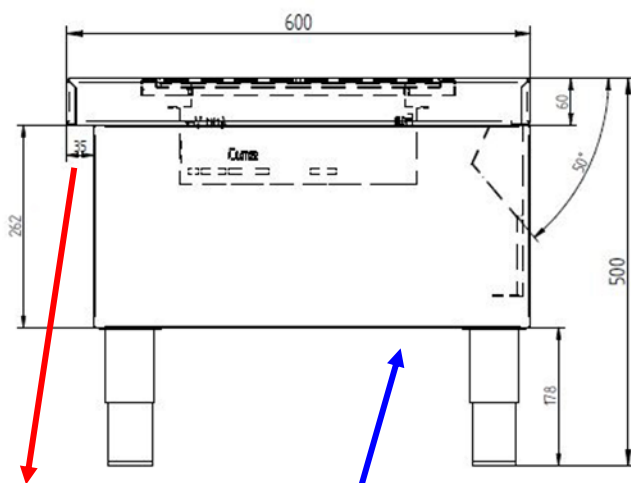

Settings	Power (W)
1	50
2	100
3	200
4	300
5	500
6	700
7	900
8	1100
9	1350
10	1600
11	1900
12	2400
13	2900
14	3500
15	4000
16	4500
17	4900
18	5300
19	5800
20	6000

Material	Stainless steel casing and vitroceramic.
Controls	Knob + led.
Power	6000 W.
Amps	10A per phases.
Power supply	400V three-phases (works between 320 and 450V / 40 and 70Hz). 440V power supply available on request.
Standards	Complies with European standards for safety of electrical appliances, for EMC and for rohs.
Conception	Design and made in France.

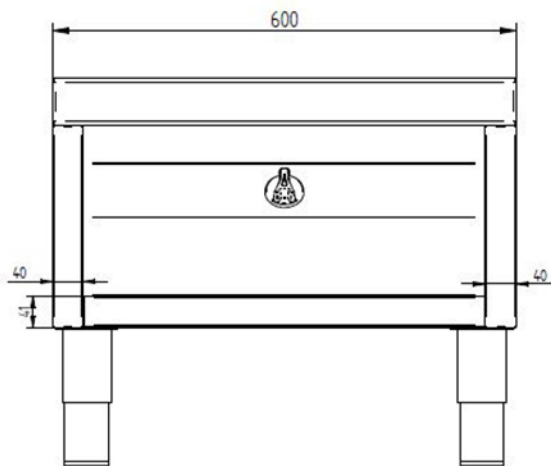

Hot air outlet

Fresh air inlet

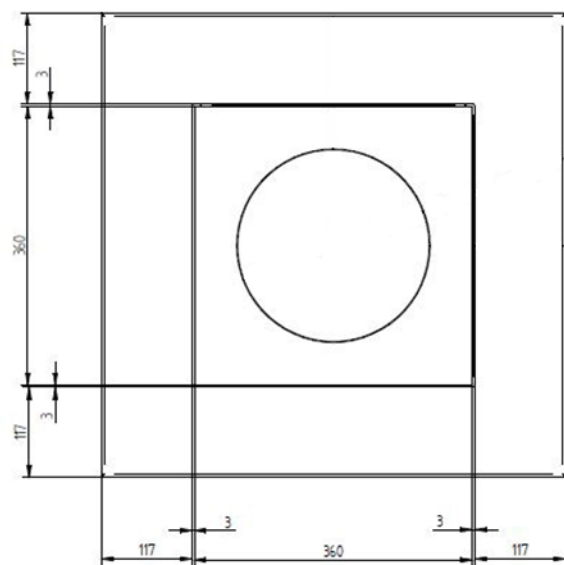

Bottom view

